



# SBX

## 1-1/8" x 1-1/8" Hose Centrifugal Transportation Circulator

The SBX 1-1/8" Hose Centrifugal Circulator Pump by MP Pumps is expertly engineered for directional booster applications involving water or coolant systems. Featuring a compact, cost-effective design, the SBX is equipped with a splash- and weather-resistant 12V or 24V DC motor, making it an ideal solution for agricultural, industrial, commercial, marine, OEM, and transportation industries.

With an impressive flow rate of up to 18 GPM (68 LPM) and a maximum head of 15 feet (4.6 m), the SBX ensures reliable performance even under demanding conditions. Built using high-quality materials, including a semi-open nickel steel impeller and durable sealing options, the SBX provides long-term operational efficiency and resilience against wear and extreme temperatures.

Whether you need robust fluid circulation in harsh outdoor environments or efficient cooling in transportation systems, the SBX delivers proven performance, durability, and versatility in one compact package.

### SPECIFICATIONS:

<b>Port Sizes</b>	1-1/8" x 1-1/8"
<b>Materials of Construction</b>	Aluminum
<b>Flow</b>	Up to 18 GPM (4 m <sup>3</sup> /h)
<b>Head Feet</b>	Up to 15' (4.6 m)
<b>Impeller</b>	2.5" (63.5 mm) semi-open nickel steel
<b>Drive Options</b>	12 & 24V DC brushed electric motor
<b>Seal</b>	Carbon / silicon carbide or silicon carbide /silicon carbide or carbon / ceramic
<b>Temperature</b>	Operation in ambient temperatures up to 200°F (93°C), Use with fluids to 220°F (104°C) and sustained fluid temps up to 210°F (99°C)
<b>Base</b>	Stamped steel with (4) vibration isolating grommets

### Application:

- Agricultural
- Commercial
- Industrial
- Marine
- OEM
- Transportation

### Features:

- Convenient directional volute port configuration
- Dual 18" long 14 AWG red (positive) black (negative) power leads

## PERFORMANCE CURVES

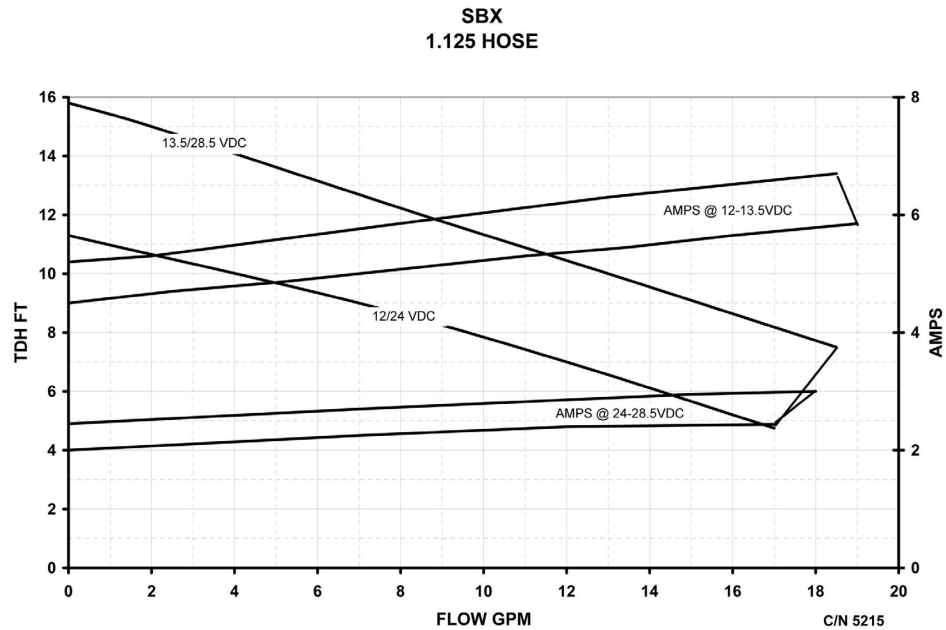

## DIMENSIONS

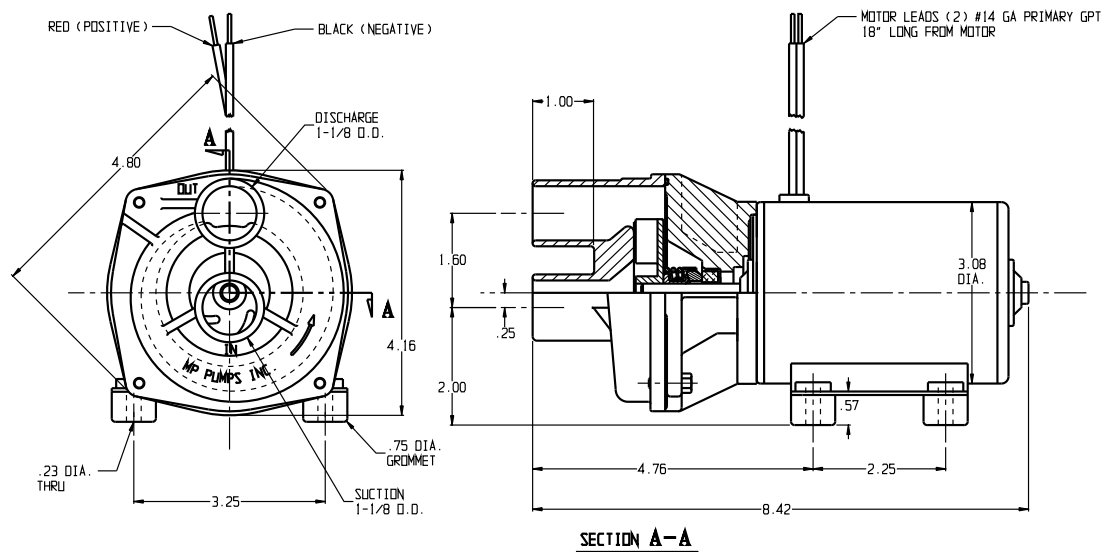

\* For complete parts lists and troubleshooting guidance, please refer to the MP Pumps Installation Operation & Maintenance (IOM) Manual.